

GC 10A-4E & GC 6A-10E Wiring

In 2003, Atwood created a new gas-electric water heater. These units improve serviceability by moving most of the components for the electric portion of the water heater to the outside except the element and relay, which remain in a junction box in the rear. One module board controls both gas and electric.

When replacing a 3E or 9E to a 4E or 10E some wiring changes are necessary. See the INFORMATION NOTICE that follows.

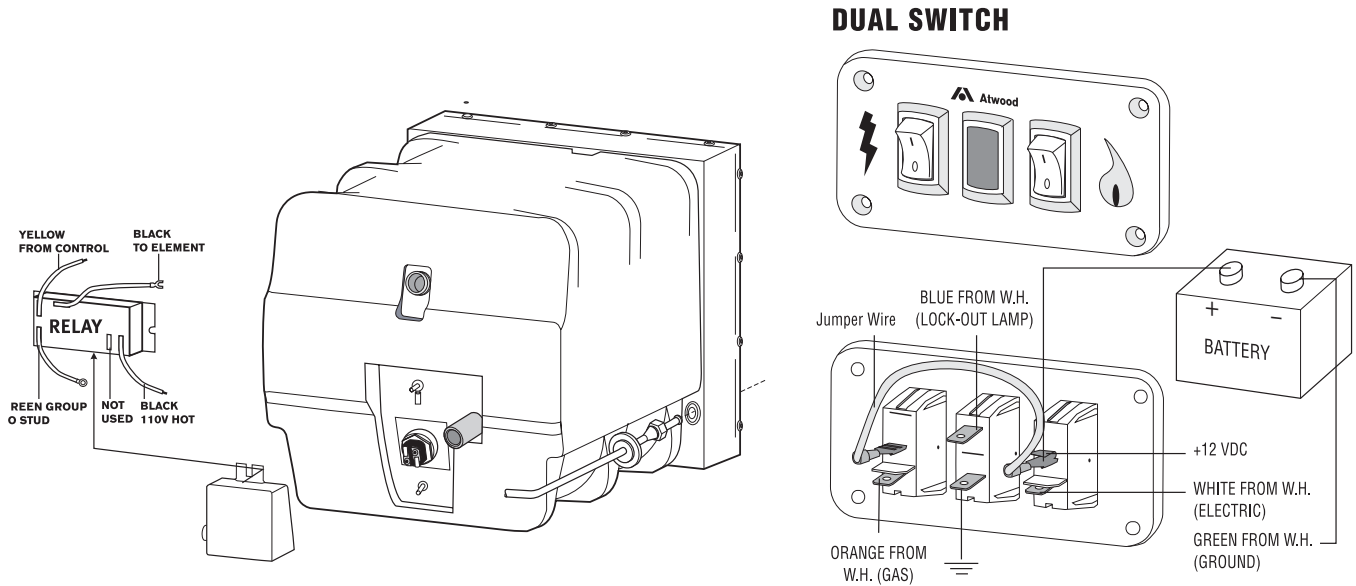

WIRING DIAGRAM COMBINATION GAS/ELECTRIC

